

CONSTRUCTION FEATURES

Bezel provides flange for flush mounting in panel

Clear plastic face is highly resistant to breakage. Provides undistorted view of pointer and scale.

Precision litho-printed scale is accurate and easy to read.

Red tipped pointer of heat treated aluminium tubing is easy to see. It is rigidly mounted on the helix shaft.

Pointer stops of moulded rubber prevent pointer over-travel without damage.

"Wishbone" assembly provides mounting for helix, helix bearing and pointer shaft.

Jeweled bearings are shock-resistant mounted; provide virtually friction-free motion for helix. Motion damped with high viscosity silicone fluid.

Zero adjustment screw is conveniently located in the elastic cover and is accessible without removing cover.

Helix is precision made from an alloy of high magnetic permeability. Mounted in jeweled bearings, it turns freely following the magnetic field to move the pointer across the scale.

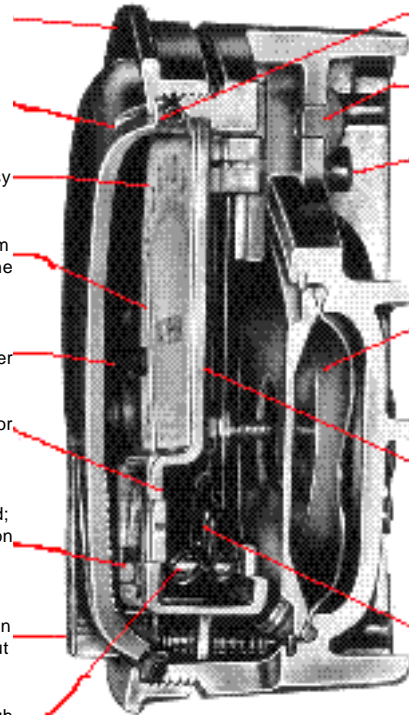

O-ring seal for cover assures pressure integrity of case

Blowout plug of silicone rubber protects against overpressure on 15 psig (1 barg) rated models. Opens at approximately 25 psig (1.7 barg).

Die cast aluminium case is precision made and iridite-dipped to withstand 168 hour salt spray corrosion test. Exterior finished in baked dark grey hammeroid. One case size is used for all standard pressure options and for both surface and flush mounting.

Silicon rubber diaphragm with integrally moulded O-ring is supported by front and rear plates. It is locked and sealed in position with a sealing plate and retaining ring. Diaphragm motion is restricted to prevent damage due to overpressures.

Calibrated range spring is flat spring steel. Small amplitude of motion assures consistency and long life. It reacts to pressure on diaphragm. Live length adjustable for calibration.

Samarium Cobalt magnet mounted at one end of range spring rotates helix without mechanical linkage.

DIMENSIONS

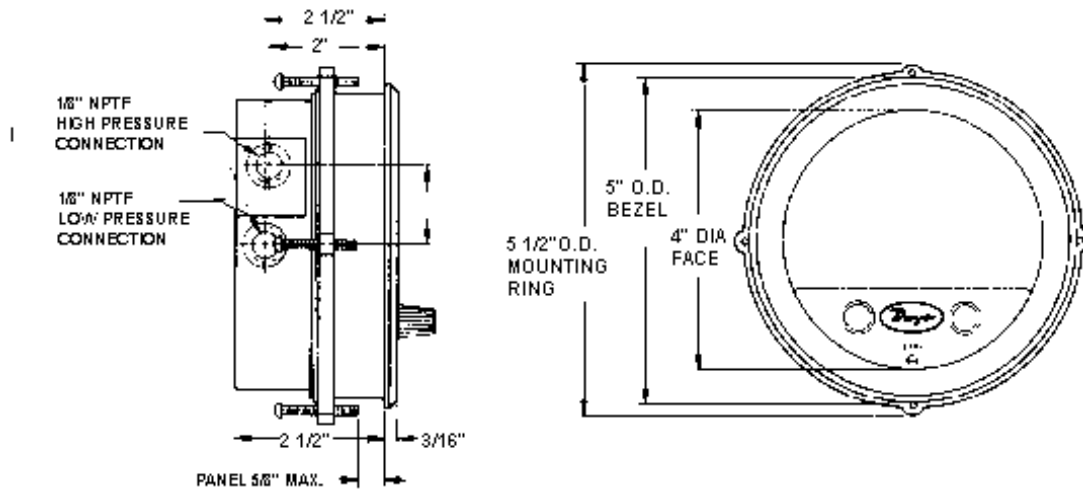

Every effort has been made during the preparation of this document to ensure the accuracy of statements and specifications. However, we do not accept liability for damage, injury, loss or expense caused by errors or omissions made. We reserve the right to withdraw or amend products or documentation without notice.

Head Office: 2 Downgate Drive, Sheffield, S4 8BT, England
Tel: +44(0)114 244 2521 Fax: +44(0)114 243 4838



RM&C Roxspur
Measurement
& Control Ltd

1 - 4 Campbell Court, Bramley, Tadley, Hampshire, RG26 5EG, England
Tel: +44(0)1256 884901 Fax: +44(0)1256 882986
email: sales@roxspur.com www.roxspur.com



CERTIFICATE NO. 22358